

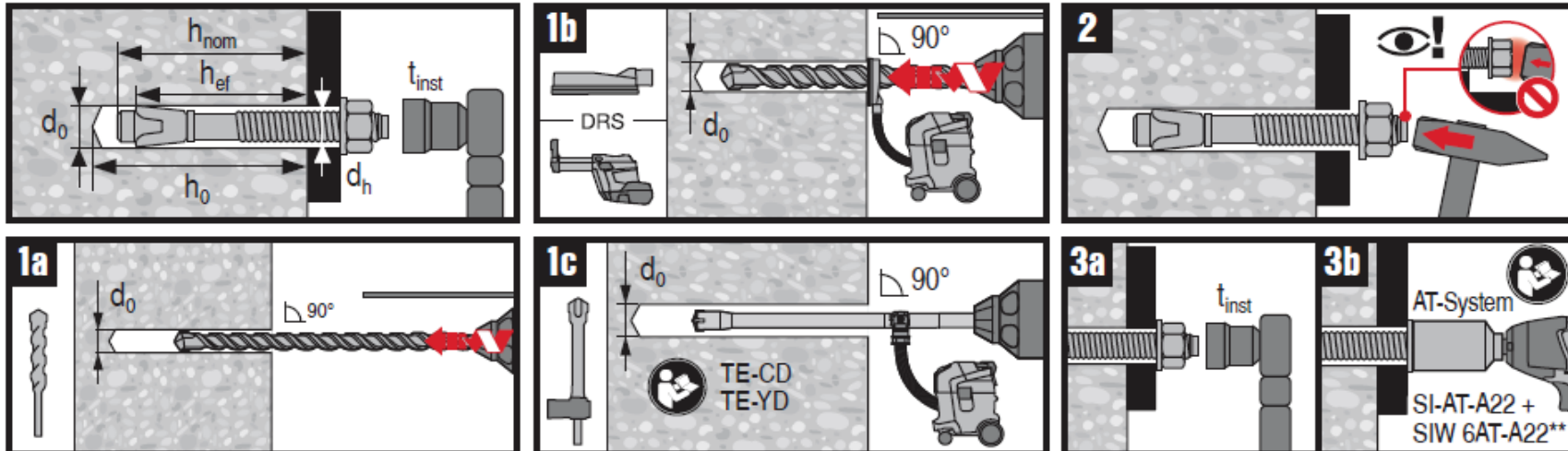

KB3/KB3 HDG/  
KB3 SS304/  
KB3 SS316

2060284 A5-02.2018



Anchor diameter	[inch]	1/4	3/8	1/2	5/8	3/4	1
		—	—	✓	✓	✓	—
		✓	✓	✓	✓	✓	—
AT-System		—	✓	✓	✓	—	—
$d_0$	[inch]	1/4	3/8	1/2	5/8	3/4	1
min. $h_0$ ***	[inch]	2	2 <sup>5</sup> / <sub>8</sub>	2 <sup>5</sup> / <sub>8</sub>   4	3 <sup>7</sup> / <sub>8</sub>   4 <sup>3</sup> / <sub>4</sub>	4 <sup>1</sup> / <sub>2</sub>   5 <sup>3</sup> / <sub>4</sub>	5   6 <sup>3</sup> / <sub>4</sub>
min. $h_{nom}$	[inch]	1 <sup>3</sup> / <sub>4</sub>	2 <sup>3</sup> / <sub>8</sub>	2 <sup>1</sup> / <sub>4</sub>   3 <sup>5</sup> / <sub>8</sub>	3 <sup>1</sup> / <sub>2</sub>   4 <sup>3</sup> / <sub>8</sub>	4 <sup>1</sup> / <sub>4</sub>   5 <sup>5</sup> / <sub>8</sub>	4 <sup>5</sup> / <sub>8</sub>   6 <sup>3</sup> / <sub>8</sub>
min. $h_{ef}$	[inch]	1 <sup>1</sup> / <sub>2</sub>	2	2   3 <sup>1</sup> / <sub>4</sub>	3 <sup>1</sup> / <sub>8</sub>   4	3 <sup>3</sup> / <sub>4</sub>   5	4   5 <sup>3</sup> / <sub>4</sub>
$T_{inst}$	[ft-lb]	4	20	40	60	110	150
$T_{inst}$ (Masonry)	[ft-lb]	4	15	25	65	120	—
$d_h$	[inch]	5/16	7/16	9/16	11/16	13/16	1 <sup>1</sup> / <sub>8</sub>
WS (Wrench Size)	[inch]	7/16	9/16	3/4	15/16	1 <sup>1</sup> / <sub>8</sub>	1 <sup>1</sup> / <sub>2</sub>

Use only carbide-tipped masonry drill bits complying with ANSI B212.15.1994

\*\*Adaptive Torque (AT) system not applicable for installation in concrete masonry unit / grout filled concrete block.

\*\*AT system not applicable for wood fastening applications and HDG anchors.

\*\*\*For a non-hole cleaning installation (step 1a or 1b), make sure to drill deep enough to achieve  $h_0$ , taking into account the depth of debris remaining in the hole