



www.wayne-dalton.com

idrive[®] Op 45 Board Replacement

Use these instructions when replacing the circuit board in the Op45 idrive[®] for TorqueMaster[®] opener.

⚠ WARNING

UNPLUG THE POWER CORD AT THE POWER RECEPTACLE OR DISCONNECT POWER AT FUSE/BREAKER BOX BEFORE ANY MAINTENANCE PROCEDURES ARE MADE. FAILURE TO DO SO, MAY RESULT IN SEVERE OR FATAL ELECTRIC SHOCK.

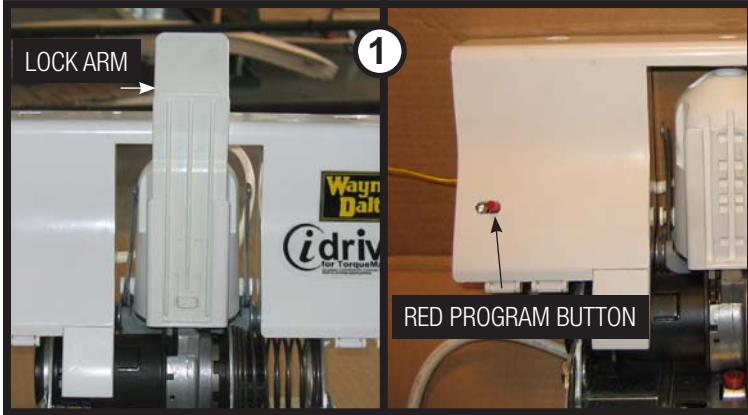

If the motor is not pivoted down the lock arm will need to be removed to open cover. To remove pull lock arm straight out from back of motor. Remove the red program button cap.

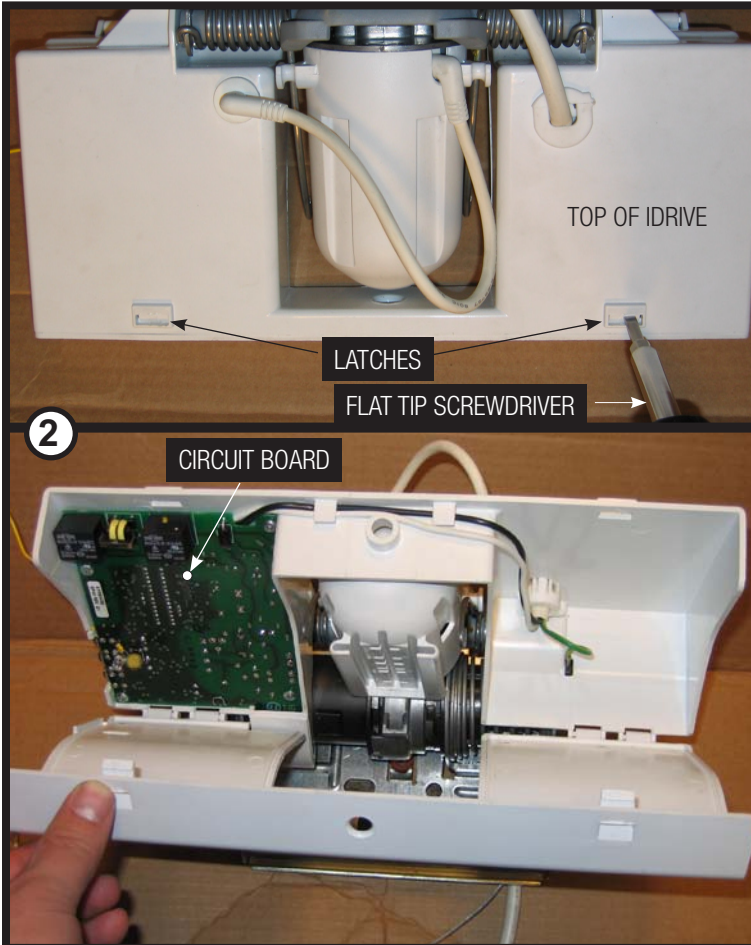

Using a flat tip screwdriver, release the latches to remove the cover and expose the circuit board.



Using a phillips head screwdriver, remove the four screws from the circuit board. Gently lower the circuit board to access wiring connections.

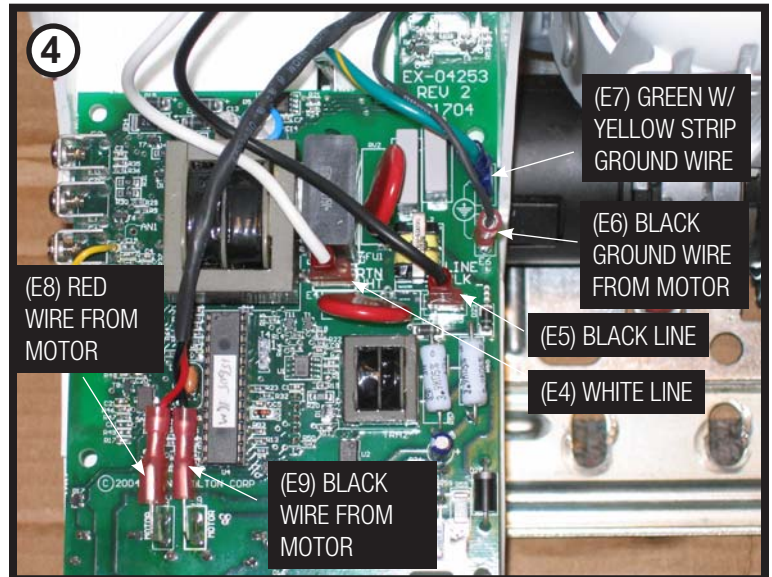

Unplug all six wires from the circuit board, making sure to note the location of each wire. Remove the old circuit board. Connect new circuit board with the wires as shown above. Place the circuit board back in the opener chassis and attach the circuit board to the chassis with the four phillips head screws. Reinstall the front cover of the opener and red program button. Reinstall lock arm to original position, if removed, using a flat tip screwdriver to lift the latch while inserting lock arm.

Plug the opener power cord in at the power receptacle or turn on the power at the fuse box. Program wall station and transmitters to new circuit board. Run the install routine to reset door limits. See Op 45 idrive[®] Owners manual.