



DoorMaster™

Change to DoorMaster Installation Instructions for new TorqueMaster Center Bracket Assembly

Use this insert in conjunction with the DoorMaster and installation manuals provided with the door. Follow the corresponding steps in this insert with the steps in the installation manuals.

IMPORTANT! It is recommended that door and operator be installed at the same time. This will eliminate the extra labor of removing the TorqueMaster system, to install the DoorMaster drive gear. Refer to back side of this insert for installing the DoorMaster to doors, which are already installed.

IF THE DOOR AND THE DOORMASTER ARE BEING INSTALLED AT THE SAME TIME

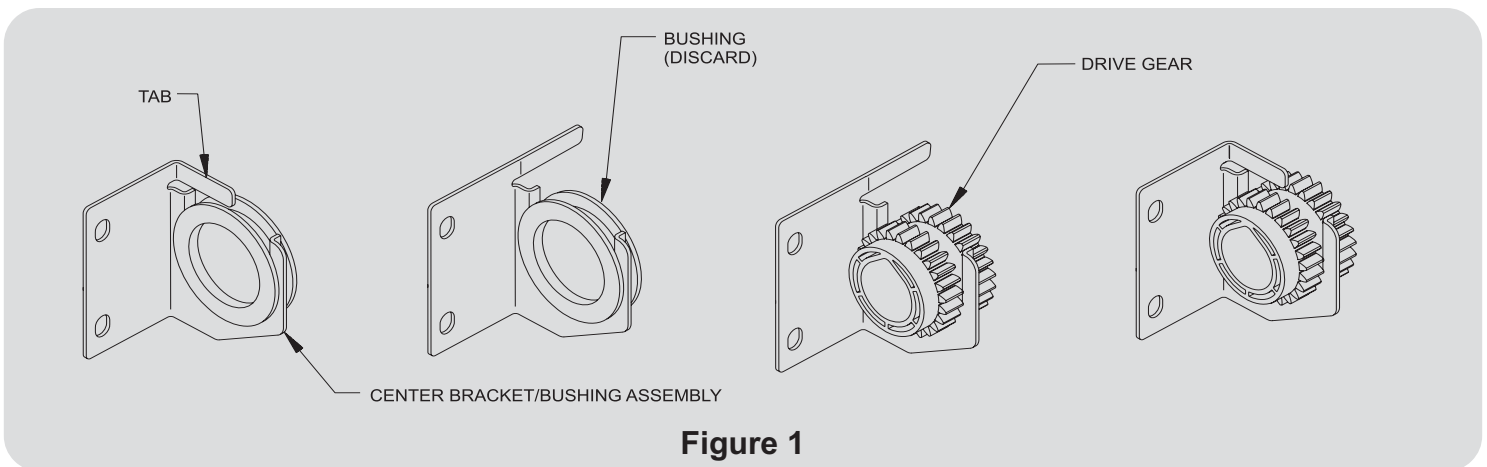

► Step 1

Bend tab on bracket/bushing assembly. Remove bushing and discard. Insert the drive gear (supplied with the DoorMaster) in place of the bushing and bend tab back over into original position. (see **Figure 1**).

NOTE: The hub of the drive gear may face to the left or right side of the door.

► Step 2

Slide TorqueMaster tube into the drive gear, so that the drive gear and center bracket are in the center of the TorqueMaster tube. (see **Figure 2**).

► Step 3

Refer to the Door Installation manual for the remaining steps.

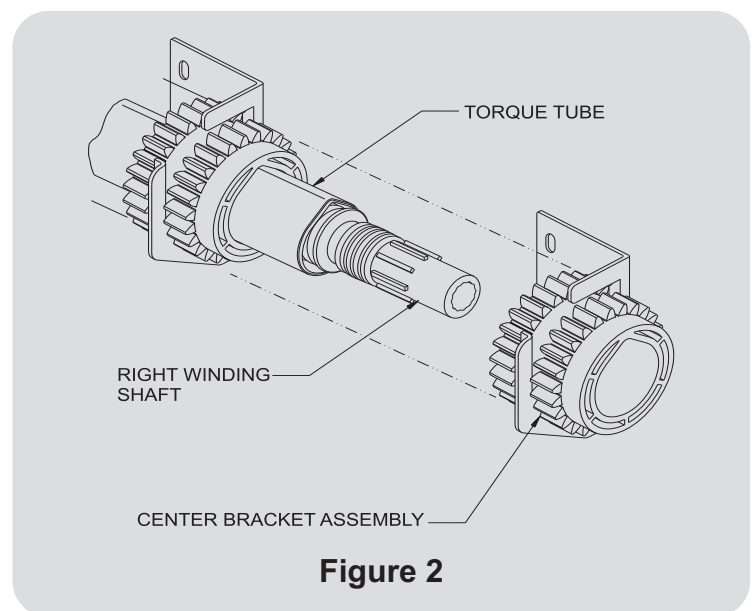

IF THE DOOR WITH THE TORQUEMASTER COUNTER BALANCE SYSTEM IS INSTALLED AND THE DOORMASTER OPERATOR IS BEING ADDED

TorqueMaster tube needs to have spring tension released and tube removed from the header to install the drive gear over the TorqueMaster tube.

NOTE: Refer to the 'TorqueMaster -Repair/Replacement Spring Program'(#283871) installation manual or the TorqueMaster Replacement Spring(#283753) insert for instructions on disassembly and reinstallation of the TorqueMaster system.

TORQUEMASTER TUBE REMOVAL FOR OLDER TORQUEMASTER ASSEMBLIES (PRE 1998)

Older TorqueMaster assemblies can be identified by: black plastic end brackets, black drive gears, black counter gear and black counter cover.

When upgrading these older TorqueMaster assemblies the following items must be replaced: cable drum assemblies, (Part #283771) and end bracket assemblies (Single Spring Part #283772, Double Spring Part #283773), counter gear, counter cover assemblies (Left/Right) and oil lubricant.

TORQUEMASTER TUBE REMOVAL FOR NEWER TORQUEMASTER ASSEMBLIES (1998 - CURRENT)

Newer TorqueMaster assemblies can be identified by: die cast end brackets and gray inner drive gears.

When up-grading the new TorqueMaster assemblies the following items must be replaced:

- If Black counter cover: replace counter gears, counter cover assemblies (Left/Right) and oil lubricant.
- If Gray counter cover: replace counter gears and oil lubricant.

NOTE: If TorqueMaster is a single spring assembly one of each component listed above is needed. If TorqueMaster is a double spring assembly two of each component listed above is needed.

► Step 1

Refer to 'TorqueMaster -Repair/Replacement Spring Program' (with Removal and Reinstallation Instruction) installation manual or the TorqueMaster Replacement Spring(#283753) insert for instructions on removal of the TorqueMaster tube for both single and double spring systems, (#283871).

► Step 2

After the TorqueMaster tube is removed, slide the drive gear over the TorqueMaster tube as described on the previous side of the page in STEP 1 (Figure 1).

► Step 3

Refer again to 'TorqueMaster -Repair/Replacement Spring Program' installation manual or the TorqueMaster Replacement Spring(#283753) insert for instruction on reinstallation of the TorqueMaster tube assembly, (#283871).

► Step 4

Refer to the DoorMaster operator installation manual to install the DoorMaster operator, (#284457).